

Press Release | Exhibition

White Arkitekter

A Heart of Wood

Sara Kulturhus in Skellefteå



Sara Kulturhus. Architecture: White Arkitekter. © White Arkitekter, Photo: Martinsons / Jonas Westling

Exhibition: 18 September – 11 November 2021

Opening: Information will follow via newsletter

Venue: Aedes Architecture Forum, Christinenstr. 18–19, 10119 Berlin

Opening Hours: Tue–Fri 11am–6.30pm, Sun–Mon 1–5pm and Sat, 18 Sep 2021, 1–5pm

The internationally active office White Arkitekter is dedicated to the renewable material wood and ecologically and socially sustainable architecture. In 2016, they designed a 20-storey building in Skellefteå in Sweden that will be one of the world's tallest timber high-rise structures. *Sara Kulturhus* – a new cultural centre right in the core of the city combining theatre, museum, art gallery, public library, conference centre and hotel – opens this year. The building, designed to reduce embodied as well as operational carbon emissions, is mainly made of wood grown in the regional boreal forests. Solar panels and efficient energy systems further contribute to minimising the project's climate footprint.

A new cultural centre

In 2016, White Arkitekter won the international design competition for the new cultural centre *Sara Kulturhus* in Skellefteå. The city is situated in the north of Sweden just below the Arctic Circle and has a long tradition of timber construction, which was the main source of inspiration for the competition proposal. White Arkitekter do not only create a new living room for the city's inhabitants, but also a showcase for sustainable design.

With an elevation of almost 80 metres, *Sara Kulturhus* houses six theatre stages, the city library, two art galleries, and a hotel with 205 rooms, a conference centre, restaurants, sky bar, and spa. The 20-storey hotel offers dramatic views over Skellefteå.

Ensuring that *Sara Kulturhus* is an "arena" for all citizens regardless of their previous interest in culture, has been a central concern for the municipality, and a starting point for the design. The location of the building and the transparent façade with many entrances work together to lower the threshold to enter the building, and to replace the image of an austere cultural institution with an open and welcoming building. *Sara Kulturhus* is aimed to enrich the community and become a new destination attracting visitors regionally, nationally, and internationally – a showcase for sustainable design and construction where all forms of culture live side-by-side.

Innovative solutions for sustainable construction

With *Sara Kulturhus* White Arkitekter aims to expand the application possibilities of wood as a construction material for complex high-rise buildings and to make progress in the field of sustainable construction. The diverse programme has called for a range of innovative solutions in solid wood construction to handle spans, flexibility, acoustics and overall statics. The hotel for example is built from prefabricated solid cross-laminated timber (CLT) volume modules stacked between two CLT lift cores. In contrast, the low-rise building is constructed with columns and beams of glulam and cores and shear walls of CLT. The architecturally integrated design allowed the load-bearing structure to be built entirely without concrete, speeding up construction time and drastically reducing the carbon footprint.

Exhibition

The exhibition *A Heart of Wood* not only provides insights into the innovative construction process, but also introduces the many social and cultural uses of this timber building giant. Using drawings, models, photographs and films, the themes are presented on expansive wooden walls. The exhibition and also the outdoor installation in front of the gallery, designed by White Arkitekter, create a meeting place where people can come together to talk, share knowledge, explore new ideas and relax.

About White Arkitekter

White Arkitekter was founded by Sidney White in 1951 and is one of Scandinavia's leading architectural practices. The employee-owned collective of about 700 staff members works with sustainable architecture, urban design, landscape architecture and interior design for current and future generations. White's mission is to enable sustainable life through the art of architecture, also with the vision that all its projects will be carbon neutral by 2030. The office has locations in Sweden, Norway, the UK, Germany, Canada and East Africa.

An Aedes catalogue will be published.

Further information:

www.aedes-arc.de

We thank the Aedes cooperation partners

Zumtobel, Cemex, Camerich, Carpet Concept

Generously supported by

Sara Kulturhus, Visit Sweden, Skellefteå kommun, Swedish Lapland, Martinsons and Holmen, Frapont, Nola

Download press pictures

<https://www.dropbox.com/sh/auqb3dgmf5y6go0/AAD26CwDVRDar8ugsEs98EVqa?dl=0>

For further information and images please contact

Mathias Schnell, Aedes Architecture Forum, +49 30 2827015, ms@aedes-arc.de

Press Pictures



Sara Kulturhus, Exterior View. © White Arkitekter, Rendering: Mir



Sara Kulturhus, Interior View. © White Arkitekter, Rendering: White Arkitekter



Sara Kulturhus, Interior View. © White Arkitekter, Rendering: White Arkitekter

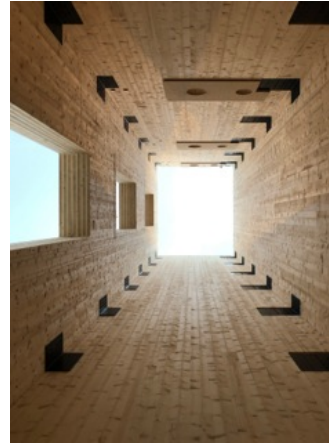

Sara Kulturhus, Elevator Shaft © White Arkitekter



Sara Kulturhus, Exterior View. © White Arkitekter, Rendering: Luxigon

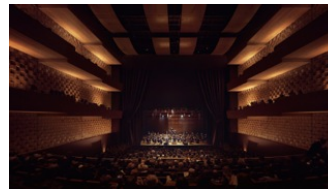

Sara Kulturhus, Theatre. © White Arkitekter, Rendering: Mir



Sara Kulturhus, Aerial View. © White Arkitekter, Photo: Jonas Westling



Sara Kulturhus, Aerial View. © White Arkitekter, Rendering: Luxigon

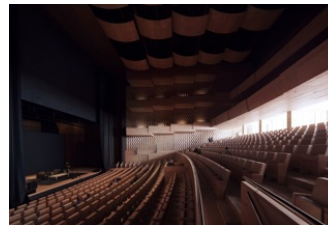

Sara Kulturhus, Theatre. © White Arkitekter, Rendering: Mir

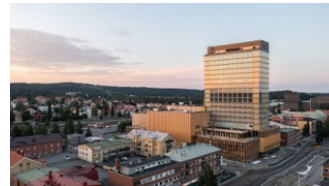

Sara Kulturhus, Aerial View. © White Arkitekter, Photo: Patrick Degerman



Sara Kulturhus, Exterior View. © White Arkitekter, Rendering: White Arkitekter

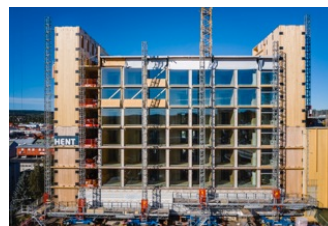

Sara Kulturhus, Exterior View. © White Arkitekter, Photo: Jonas Westling



Sara Kulturhus, Exterior View. © White Arkitekter, Photo: Jonas Westling



Sara Kulturhus, Exterior View. © White Arkitekter, Photo: Åke Eson Lindman

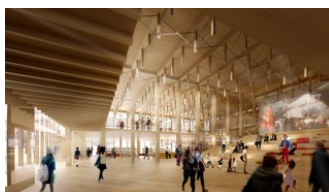

Sara Kulturhus, Interior View. © White Arkitekter, Rendering: White Arkitekter

Aedes



Sara Kulturhus, Exterior View. © White Arkitekter, Photo: Åke Eson Lindman



Sara Kulturhus, Exterior View. © White Arkitekter, Photo: Åke Eson Lindman



Sara Kulturhus, Interior View. © White Arkitekter, Photo: Åke Eson Lindman



Sara Kulturhus, Exterior View. © White Arkitekter, Photo: Åke Eson Lindman

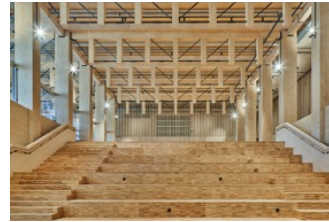

Sara Kulturhus, Interior View. © White Arkitekter, Photo: Åke Eson Lindman



Sara Kulturhus, Exterior View. © White Arkitekter, Photo: Åke Eson Lindman



Sara Kulturhus, Interior View. © White Arkitekter, Photo: Åke Eson Lindman



Sara Kulturhus, Interior View. © White Arkitekter, Photo: Åke Eson Lindman



Sara Kulturhus, Façade. © White Arkitekter, Photo: Åke Eson Lindman



Sara Kulturhus, Interior View. © White Arkitekter, Photo: Åke Eson Lindman



Sara Kulturhus, Interior View. © White Arkitekter, Photo: Åke Eson Lindman



Sara Kulturhus, Interior View. © White Arkitekter, Photo: Åke Eson Lindman